

Notice to Mariners – Hornsea Four

Update: Holderness Coast Offshore Geophysical Survey

1. INTRODUCTION

Mariners are advised Hornsea Four Offshore Wind Farm will be carrying out offshore geophysical survey from 15 May 2019 (weather dependent) within the UK Sector of the North Sea off the East Yorkshire coast, as shown in Figure 1 of this notice.

Survey completion is now anticipated by mid July 2019.

2. AREA OF OPERATIONS

Activities will centre on the offshore sections of the Hornsea Four Offshore Wind Farm proposed export cable route. Survey box coordinates are provided below.

Mariners are advised MaxSea and Olex plotter files can be provided by the Onshore Fisheries Industry Representative and Brown & May Marine Limited. Contact details listed below.

The survey vessel will be towing survey equipment and therefore requires an adequate buffer to allow for turning circles, included within the survey box coordinates provided below.

The survey vessel will be deployed to locations within the survey area at times and positions determined by client requirements, weather and sea conditions.

3. COORDINATES

Latitude	Longitude
54° 4.810' N	0° 24.111' E
54° 5.023' N	0° 24.189' E
54° 4.688' N	0° 26.820' E
54° 4.472' N	0° 26.748' E
54° 3.438' N	0° 31.120' E
54° 2.882' N	0° 31.821' E
54° 2.362' N	0° 37.383' E
54° 2.567' N	0° 37.524' E
54° 1.977' N	0° 39.675' E
54° 1.772' N	0° 39.531' E
54° 0.519' N	0° 42.764' E
54° 1.121' N	0° 45.302' E
54° 1.377' N	0° 45.314' E
54° 1.570' N	0° 46.693' E
54° 1.351' N	0° 46.893' E

54° 1.338' N	0° 48.157' E
54° 0.029' N	0° 57.810' E
54° 0.569' N	1° 3.161' E
54° 3.196' N	1° 7.674' E
54° 2.671' N	1° 8.637' E
53° 57.700' N	1° 13.362' E
53° 57.781' N	1° 11.177' E
53° 59.604' N	1° 2.390' E
53° 59.206' N	0° 59.000' E
53° 58.998' N	0° 59.101' E
53° 59.022' N	0° 56.401' E
53° 59.254' N	0° 56.336' E
54° 0.424' N	0° 48.044' E
54° 0.431' N	0° 47.085' E
53° 59.302' N	0° 42.570' E
54° 0.151' N	0° 40.015' E
54° 0.322' N	0° 40.237' E
54° 1.397' N	0° 37.781' E
54° 1.961' N	0° 31.740' E
54° 1.844' N	0° 29.530' E
54° 3.056' N	0° 24.711' E
54° 3.204' N	0° 16.779' E
54° 3.476' N	0° 13.866' E
54° 3.556' N	0° 13.857' E
54° 3.389' N	0° 9.600' E
54° 2.397' N	0° 6.686' E
54° 2.143' N	0° 6.651' E
54° 2.176' N	0° 2.553' E
54° 1.058' N	0° 1.338' W
54° 1.059' N	0° 1.338' W
54° 0.757' N	0° 7.108' W
54° 4.041' N	0° 6.023' W
54° 4.131' N	0° 4.116' W
54° 3.298' N	0° 6.259' E
54° 4.261' N	0° 8.107' E
54° 4.513' N	0° 10.656' E
54° 4.472' N	0° 13.759' E
54° 4.638' N	0° 13.741' E
54° 4.935' N	0° 16.465' E

Reference: 02995977_A

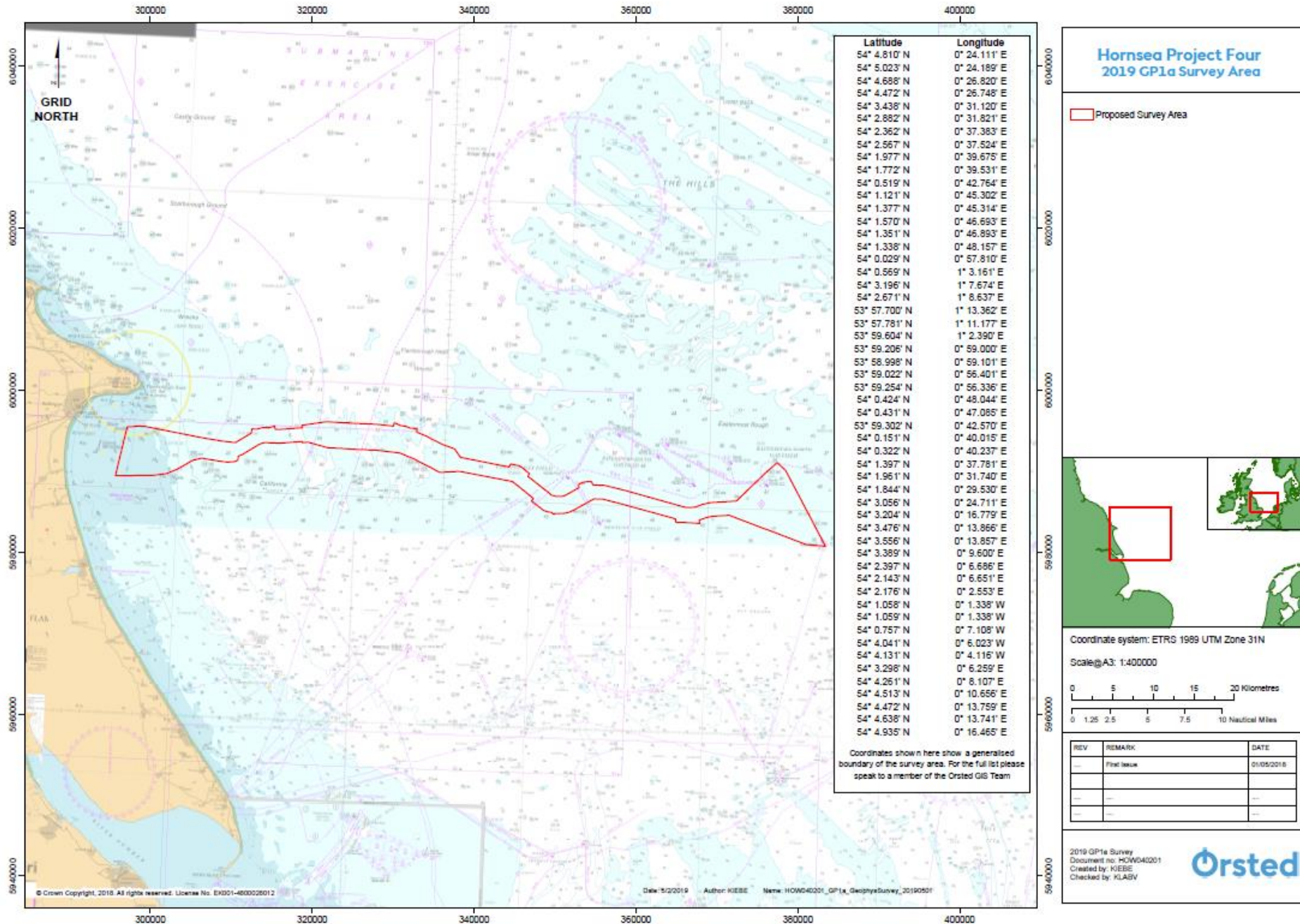

e: 02995977_A

Figure 1. Hornsea Four Offshore Wind Farm Holderness Coast Offshore Geophysical Survey Area.

4. SURVEY

Reference: 02995977_A

Hornsea Four Offshore Wind Farm will be carrying out geophysical survey with the vessels Bibby Tethra and Fugro Pioneer. A local scout vessel is also contracted to reduce potential for static fishing gear interactions.

The survey area will be covered using a full geophysical survey spread including towed equipment and seabed Sampling. It is requested that all vessels operating within the area keep a safe distance (at least 500m) and pass at minimum speed/reduced wash.

5. SAFETY

It is requested that anybody having prior knowledge of potentially submerged or moored objects on the seabed within the survey area, which could form a hazard to the survey vessel and/or equipment, advises the Onshore Fisheries Industry Representative or Brown & May Marine Limited.

During survey a listening watch will be maintained on VHF Channels 12 and 16 when within the appropriate port authority area and will actively transmit an AIS signal. The survey vessels will also broadcast at regular daily intervals the vessel position, operational information and its intentions.

6. IMMEDIATE CONTACTS

Ørsted Project Manager – Trier Pedersen	
Tel: +45 99 55 87 42	Email: NTPED@orsted.dk
BIBBY TETHRA Vessel Manager – Simon Baldwin	
Tel: +44 (0)151 328 1120 Mob: +44 (0)758 391 9661	Email : Simon.Baldwin@bibbyhydromap.com
Fugro Pioneer Vessel Manager – Darren Baylis	
Tel: +44 2392 205 528 Mob: +44 07789 643 986	Email : d.baylis@fugro.com

7. FISHERIES LIAISON

Onshore Fisheries Industry Representative – Nick Garside	
Mob: +44 (0)7538 827 013	Email: nick.garside@live.co.uk
Brown & May Marine Ltd – Alex Winrow-Giffin	
Mob: +44 (0)7760 160 039	Email: alex@brownmay.com

An Offshore Fisheries Liaison Officer will be on-board the survey vessel during the works, contactable on VHF channel 16.

In the event the Onshore Fisheries Liaisons are not contactable, please direct fisheries enquiries related to these survey works to the Ørsted Company Fisheries Liaison Officer:

Reference: 02995977_A

Company Fisheries Liaison Officer – Sophie Farenden	
Mob: +44 755 117 6795	E-mail: XSFAR@orsted.co.uk

8. VESSELS

Survey Vessel – BIBBY TETHRA	
GSM +44 7920 075 745 VSAT +44 151 203 0865	Vessel Email: Bibby.Tethra@bibbyhydromap.com Party Chief Email: pc.Bibby.Tethra@bibbyhydromap.com

Name	Bibby Tethra
Flag	British
MMSI Number	235084836
Call Sign	2EGF8



Length	27.5m
Breadth	10.m
Draught	3.3m
Engine	2 x Cummins KTA19 M3 HD (477kW each)

Issued: 4 June 2019

Survey Vessel – FUGRO PIONEER

Party Chief: +31 10 7130 946
VSAT: +31 10 7130 944

Vessel Email (Fugro Party Chief):
pc@pio.fugro.com

Reference: 02995977_A

Name	Fugro Pioneer
Flag	Bahamas (BS)
Year Built	2014
MMSI Number	311000262
Call Sign	C6BH3
Class	DNVGL (Research / Survey Vessel)



Length	53.63m
Breadth	12.5m
Draught	3.1m
Engine	2 x Azimuth thrusters, 1 x tunner thruster (bow)